

## F100MC Series

100W single output with c.v circuit and PFC function

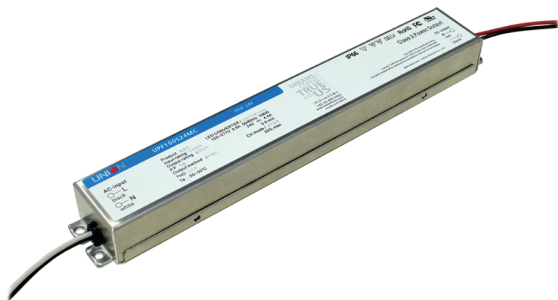

- Constant voltage design
- Built-in PFC function
- Wide input range
- Protections: Over load / Over voltage / Short circuit / Over temperature
- 100% full load burn-in test
- Suitable for LED lighting and moving sign applications
- Safety standards : UL879
- EMC standards : FCC Part 15 classB
- Metal case
- 5years warranty

IP66 SELV    

ITEM		UPF100S24MC
INPUT	VOLTAGE RANGE	AC120/277V±10%
	FREQUENCY RANGE	50/60Hz
	POWER FACTOR	>0.9 under 120/277Vac input with 80~100% load condition
	TOTAL HARMONIC DISTORTION	≤20% under 120/277Vac input with 80~100% load condition
	EFFICIENCY(typ.)	90%(AC120V), 92.5%(AC240V), 92.5%(AC277V)
	AC CURRENT(typ.)	0.9A/AC120V, 0.45A/AC240V, 0.39A/AC277V
	INRUSH CURRENT(typ.)	COLD START 40A/240VAC
	LEAKAGE CURRENT	<1mA / 240VAC
OUTPUT	RATED CURRENT	4.0A
	DC VOLTAGE	24V
	RATED POWER	96W
	RIPPLE&NOISE(max.) Note2	1000mVp-p
	SETUP,RISE TIME(max.)	3000ms,100ms/120VAC at full load    3000ms,100ms/240VAC at full load
	HOLD UP TIME(typ.)	2ms/120VAC at full load    2ms/240VAC at full load
PROTEC-TION	OVER CURRENT Note3	Over 100% of rating ; recovers automatically after fault condition is removed
	SHORT CIRCUIT	Hiccup or shut down mode / recover : automatically or need reapplying power
	OVER TEMPERATURE	recovers automatically after fault condition is removed
ISOLA-TION	WITHSTAND VOLTAGE	I/P-O/P:AC1.6KV
	ISOLATION RESISTANCE	I/P-O/P:DC500V 100Mohms(At room temp. & humid.)
ENVIRON-MENT	WORKING TEMP.&HUMID.	-30~+50℃(Refer to "DERATING CURVE),20~95%RH
	STORAGE TEMP.&HUMID.	-40~+80℃,10~95%RH
	VIBRATION	10~500Hz, 5G 12min./1cycle, period for 72min. each along X, Y, Z axes
OTHERS	DIMENSION/WEIGHT	215*33.5*20.2mm(L*W*H)/0.26Kg
NOTE	1. All parameters not specially mentioned are measured at 240vac input, rated load and 25℃ of ambient temperature. 2. Ripple & noise are measured at 20MHz of bandwidth by using a 12" twisted pair-wire terminated with 0.1 uF & 47uF parallel capacitor. 3. Refer to "DRIVING METHODS of ELECTRONIC LOAD" 4. Life Rating : 50,000 hours at Tc ≤ 70℃ maximum case hot spot temperature. 5. Maximum Case Temperature : 95℃	

# S.M.P.S

# LED Converter

## BLOCK DIAGRAM

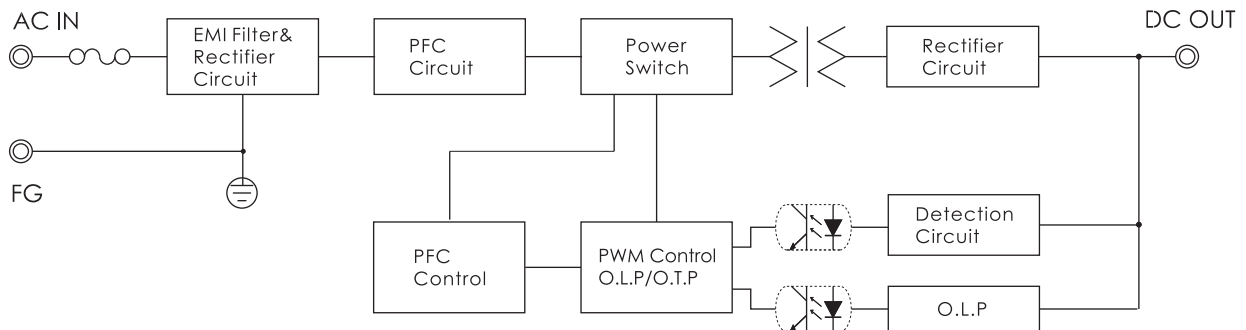

## DIMENSIONS(unit:mm)

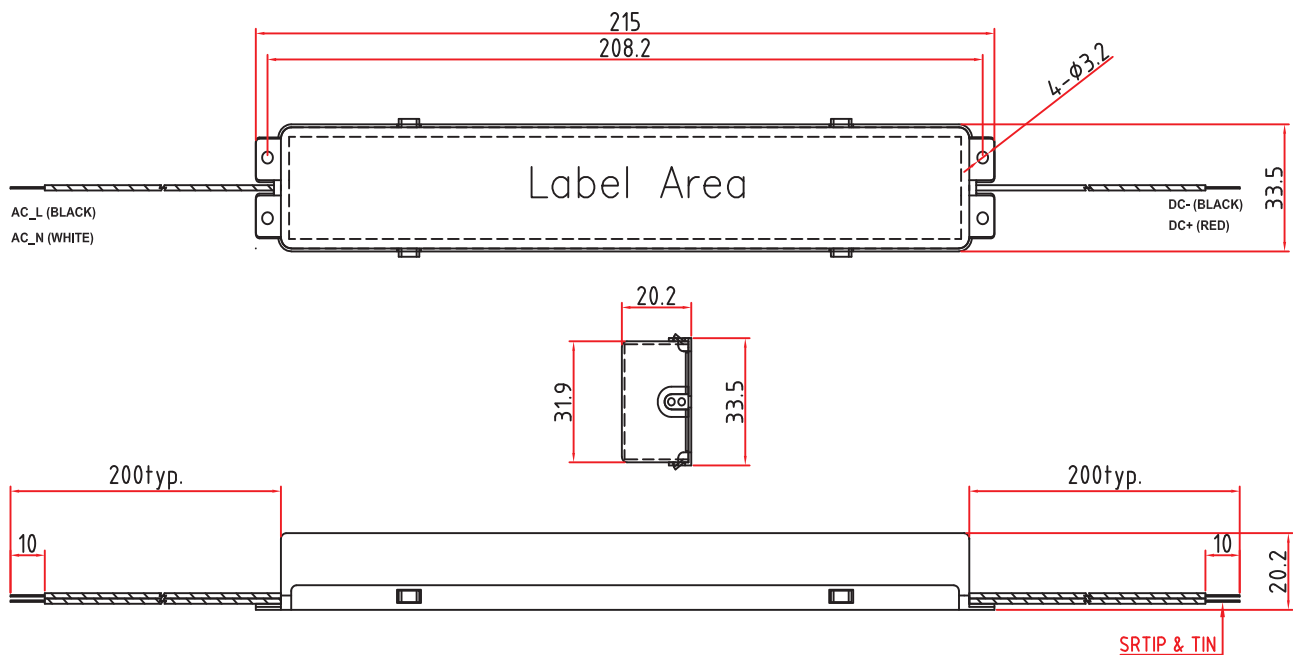

## DERATING CURVE

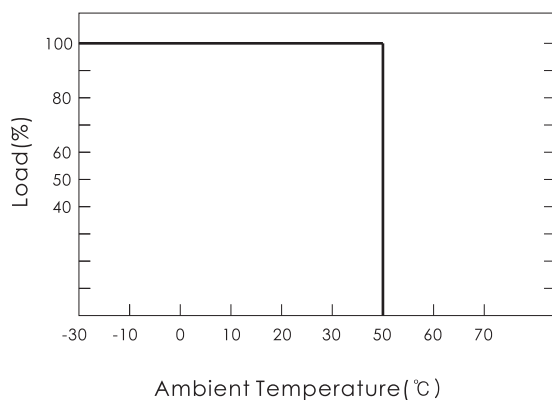

## STATIC CHARACTERISTICS

